

FREE

Admission for Children Under 5

Admission to Horse Shows in William Street Lot
Seating for All Grandstand Shows / Events
Parking for Barrier Free Access behind Main Stage
Entrance to Animal Land

ADMISSION RATES

All prices include H.S.T.

Thursday

Ages 5 to 12 years-\$2; 13 years & over-\$9

Friday and Saturday

Ages 5 to 12 years-\$2; 13 years & over-\$10

Sunday

Ages 5 to 12 years-\$2; 13 years & over-\$8

Parking: \$2.00 in the William Street Lot

ADVANCE RIDE PASSES

Pay-One-Price for Unlimited Rides

\$28.00 Advance Purchases prior to July 23rd

Hwy 15 & 32: The Junction Restaurant

Athens: Laine's Coffee & Convenience

Athens: Willard's Bakery

Brockville: Home Hardware

Brockville: Ritchie Feed and Seed

Delta Country Market

Delta: Lower Beverley Lake Park

Elgin: Akop's Pharmacy

Elgin: Gordanier Hardware

Gananoque: Robeson's General Store

Lyndhurst Home Building Centre

Lyndhurst: Wing's Live Bait

Portland: Ultramar Gas Station

Smiths Falls: Mr. Gas, Union Street

Smiths Falls: Mr. Gas, Lombard Street

Toledo: Kitley Grocery

Westport: Village Esso

SATURDAY BARBECUE at 4:00 p.m.

½ Chicken: \$12.00 / ¼ Chicken: \$9.00

MENU

Chicken, Salads, Rolls, Beverages, Doughnuts

HIGHLIGHTS

July 23rd

Mini King & Queen Pageant

Clarol the Clown - Children's Races

Wagon Rides - Ambassador Pageant

Chainsaw Log Carving - Official Opening

Jimmy Flynn - Texas Tuxedo

July 24th

Ry-Guy Magic Show - Scavenger Hunt

Bowmanville Zoo with Camel Rides

Big Time Pro Wrestling - Bob Burtch Band Wagon

Rides - Chainsaw Log Carving

Motor Madness - Mechanical Bull Rides

July 25th

Leeds 4-H Sheep Club - Family Horse Show

Horse Draw - Lawn Mower Races - Baby Show

Bowmanville Zoo with Camel Rides

Illusionist Lucas Wilson - Goat Show

Chainsaw Log Carving - Chicken Barbecue

Irish Roots - David Frizzell - Yuk Yuk's Comedy

July 26th

Leeds 4-H Dairy Club - Pet Show

Western Horse Show - Antique Tractor Pull

Arm Wrestling Competition - Little California

Children's Pedal Tractor Pull

Motorcycle Display - Cheer for a Year Raffle

DAILY

Main Exhibition Hall: 10 a.m. to 9 p.m.

Animal Land: 12 p.m. to 6 p.m.

World's Finest Shows Midway

July 23rd: 1 p.m. to 10 p.m.

July 24th: 12 p.m. to 10 p.m.

July 25th: 11:00 a.m. to 10:00 p.m.

July 26th: 12 p.m. to 6 p.m.

"The People's Holiday"

DELTA FAIR

185th Annual Edition

July 23rd to July 26th

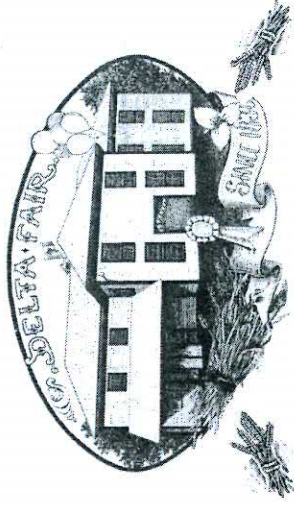

Sponsored by the

Delta

Agricultural Society

And

Funded by the

Government of Ontario



ONTARIO
Years to discover

Telephone: 613-928-2800

Email: deltafair@ripnet.com

Website: www.deltafair.com



ACKNOWLEDGEMENTS 2015

The Delta Agricultural Society would like to extend a heartfelt vote of thanks to the following businesses, individuals and organizations for their most generous support of the 185th Annual Delta Fair.

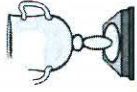

Grand Champion

Contributions Valued over \$1000

Athens Pharmasave, Athens
Barker, Linda & Harry, Portland
Canada Summer Jobs Program
Limerick Environmental, Brockville
Lower Beverley Lake Park, Delta
Morris, William, Delta
Ontario Ministry of Agriculture and Food
Ontario Ministry of Tourism
Ontario Tourism Marketing Partnership
Smith's Farm Equipment, Smiths Falls
Tackberry Construction Ltd., Athens
Tor-mac Tree Services, Toledo
Willows Agriservices, Delta
World's Finest Shows, Brantford

Red Ribbon Partner

Contributions Valued at \$500 - \$999

Halladay, Jeff & Sharon, Toledo
Kudrinko's Country Grocer, Westport
Molson Canada Breweries
Morris, Vivian, Delta
Nichols Plumbing & Electric, Toledo
Plum Hollow Excavating, Plum Hollow
Sheridan-Griffiths, Ruth, Delta
Township of Rideau Lakes
Weagant's Farm Equipment, Brockville
White, Sherron, Delta
Willard's Bakery Products, Athens

Blue Ribbon Patron

Contributions Valued at \$250 - \$499

Athens Mural, Athens
Beattie Dodge Chrysler, Brockville
Clark, Steve, M.P. Leeds-Grenville
Cooperator's Insurance, Brockville
Delta Country Market, Delta
Dixie & Egan Ltd., Addison
Elgin Lions Club, Elgin
Foley Mountain Mechanical, Westport
Lyndhurst Home Building Ctr, Lyndhurst
Lyons Goodfellow Furniture, Westport
Kelsey's Marina, Charlestown Lake
Mike Fair Chevrolet, Smiths Falls
Rathwell, Connie & Brent, Delta
REMAX, Jeff Hart, Delta
Rideau Insurance Services, Westport
Scotland Funeral Home, Elgin
Street Motor Sales, Smiths Falls
Town & Country Chrysler, Smiths Falls

White Ribbon Supporter

Contributions Valued at \$100 - \$249

Athens Carpet Plus, Athens
Athens Lions Club, Athens
Athens Veterinary Service, Athens
Baker's Feed Store, Forfar
Banks, Jeff, Lombardy
Beverley Senior Citizens' Club, Delta
Bank of Montreal, Athens
Blanchard's Garage, Athens
Burt Hudson Real Estate, Athens
D.G. Young Concrete Vaults, Godfrey
Delta Mill Society, Delta
Denaut Mansion / Country Inn, Delta
Fleming, Sam, Delta
Frontenac Municipal Law Enforcement
Green Gecko, Lyndhurst
Gordania Freshmart, Elgin
Gun-Mart, Brockville
Hartin Automotive/Truck Repair, Portland
Hartin Wheel Alignment, Elgin
Healey Transportation Ltd., Smiths Falls
Impression Printing, Smiths Falls
J. B. Kelly Insurance Broker, Brockville
Jake's Automotive Service, Elizabethtown
John Eyre Insurance Services, Elgin
Judson Funeral Home, Athens
Leeds County Plowmen's Association
Leeds Transit Inc., Elgin
Kitley Grocery & Service, Toledo
Kingston Seamless Eve Trough, Kingston
McCann Building Services, Athens
Mensen Farm Market Garden, Delta
Miller's General Repair, Addison
Monaghan, Jane, Solicitor, Elgin
Petals & Presents, Elgin
Provincial Paving, Lyndhurst
R. E. Wills Sound Systems, Odessa
Retired Women Teachers of Ontario
Rideau Lakes Building Centre, Crosby
Russell, Ward & Shirley, Burlington
The Cove Country Inn, Westport
Thousand Islands Concrete, Brockville
TRS Heating & Cooling, Brockville
WTC Communications, Westport
Wilson's Tent & Trailer Park, Lyndhurst
Wing's Live Bait & Tackle, Lyndhurst

Yellow Ribbon Friend

Contributions Valued Up To \$99

Bayview Yacht Harbour, Portland
Cedar Knoll Campgrounds, Delta
Dad's Barber Shop, Tincap
Jeannie's Fries, Cheryl Simpson, Hwy 15
Elgin Bowling Lanes, Elgin
Hartington Farm Equipment, Hartington
Howard Campbell & Sons Ltd., Lyn
Kilborns on the Rideau, Newboro
Livingston, Cathy, Delta
Lyndway Hills Golf Course, Lyndhurst
Rideau Restaurant, Elgin
Tincap Berry Farm, Brockville

Fair Committee Contacts

Agricultural Awareness	Sharon Halladay	275-2857
Agricultural Produce	Ernie Curtis	928-2964
Ambassador Pageant	Tricia Laming	802-9607
Arm Wrestling	Sharon Halladay	275-2857
Barbecue	Melinda Cowan	924-1849
Bavarian Garden	Angela Ferguson	928-3383
Children's Activities	Tricia Laming	802-9607
Concessions	Marlaire Hart	924-2407
Entertainment	William Morris	928-2800
Executive	Charles Nichols	275-2762
4-H Competitions	Brenda Dunster	342-0014
Finance	Tracy Perrin	928-2272
Hall Rental/Dance	Sherron White	928-2255
Homecraft	Heather Young	928-3202
Horses	Lois Milne	928-2800
Horse Draw	Brian Hart	924-2407
Horticulture	Pat Best	359-5503
Labour	Steve Ball	928-2006
Lawn Mower Races	Brenda Perrin	803-3880
Livestock	Ed Cavanagh	275-2113
Motorcycle Display	John Kitson	803-5927
Official Opening	Linda Barker	272-2533
Promotion	Cathy Livingston	928-2796
Property	Art Cowan	924-1849
School Exhibits	Ruth Sheridan	928-2092
Sponsorship	Sherron White	928-2255
Tractor Pull	Tricia Laming	802-9607



Complete Program Inside

Thursday, July 23rd, 2015

SPONSOR OF THE DAY

**ATHENS
PHARMASAVE**

ATHENS 613-924-20701

9:00 a.m. Homecraft /Ag. Produce Judging
 12:00 p.m. Animal Land Opens (A)
 12:00 p.m. Mini King & Queen Pageant (I)
 1:00 p.m. Clarol the Clown Magic Show (B)
 1:00 p.m. Horse Drawn Wagon Rides
 1:00 p.m. Chainsaw Log Carving
 2:00 p.m. Children's Races (M)
 3:00 p.m. Clarol the Clown Magic Show (B)
 3:00 p.m. Chainsaw Log Carving
 5:00 p.m. Ambassador Pageant (M)
 5:00 p.m. Chainsaw Log Carving
 6:30 p.m. Official Opening (M)
 Announcement of Fair Ambassador
 Citizen of the Year Presentation
 Jimmy Flynn Comedy Show (M)
 Mature themed show
 Texas Tuxedo (M)
 Main Exhibition Hall Closed
 Grounds Closed

SHOW LOCATIONS

Animal Land (A) Horse Ring (H)
 Band Shell (B) Infield (I)
 Cattle Barn (C) Main Stage (M)
 Goat/Sheep Barn (G) Pavilion (P)



SPECIAL PRICES FOR THURSDAY

1 Coupon Discount on All Rides
 1:00 p.m. to 4:00 p.m.

MIDWAY SPECIAL

Pay-One-Price for Unlimited Rides
 1:00 p.m. to 10:00 p.m.
 \$28.00 Advance Purchase
 must be made prior to July 23rd

Friday, July 24th, 2015

SPONSOR OF THE DAY

**TOR-MAC
TREE SERVICES**

TOLEDO 613-275-2586

10:00 a.m. Main Exhibition Hall Open
 12:00 p.m. Animal Land Opens (A)
 Bowmanville Exotic Animal Display
 With Camel Rides
 Ry-Guy Magic Show (B)
 12:00 p.m. Chainsaw Log Carving
 1:00 p.m. Scavenger Hunt (I)
 1:00 p.m. Big Time Pro-Wrestling 2015 (M)
 1:00 p.m. Horse Drawn Wagon Rides
 2:00 p.m. Ry-Guy Magic Show (B)
 2:00 p.m. Bob Burtch Band (B)
 3:00 p.m. Fill Your Face Eating Contest (I)
 3:00 p.m. Chainsaw Log Carving
 4:00 p.m. Ry-Guy Magic Show (B)
 5:00 p.m. Chainsaw Log Carving
 6:00 p.m. Ry-Guy Magic Show (B)
 7:00 p.m. Motor Madness (M)
 7:00 p.m. Mechanical Bull Challenge (P)
 8:30 p.m. DJ Rock Wizard (P)
 9:00 p.m. Main Exhibition Hall Closed
 11:00 p.m. Grounds Closed

SHOW LOCATIONS

Animal Land (A) Horse Ring (H)
 Band Shell (B) Infield (I)
 Cattle Barn (C) Main Stage (M)
 Goat/Sheep Barn (G) Pavilion (P)



MIDWAY SPECIAL

Pay-One-Price for Unlimited Rides
 12:00 p.m. to 10:00 p.m.
 \$28.00 Advance Purchase
 must be made prior to July 23rd

Saturday, July 25th, 2015

SPONSOR OF THE DAY

**WILLOWS
AGRISERVICES**

DELTA 800-742-5850

9:00 a.m. Leeds 4-H Sheep Club Achievement
 9:00 a.m. Family Horse Show (H)
 10:00 a.m. Main Exhibition Hall Open
 10:00 a.m. Horse Draw (M)
 11:00 a.m. Baby Show (I)
 11:00 a.m. Chainsaw Log Carving
 12:00 p.m. Animal Land Opens (A)
 Bowmanville Exotic Animal Display
 With Camel Rides
 Scavenger Hunt (I)
 12:00 p.m. Goat Show (G)
 12:00 p.m. Leeds County 4-H Cloverbuds (C)
 12:30 p.m. Lucas Wilson Illusionist (B)
 1:00 p.m. Irish Roots (B)
 2:00 p.m. Talent Show (I)
 2:00 p.m. Chainsaw Log Carving
 2:30 p.m. Lucas Wilson Illusionist (B)
 2:00 p.m. Lawn Mower Races (M)
 3:00 p.m. Irish Roots (B)
 4:00 p.m. Chicken Barbecue (P)
 4:00 p.m. Chainsaw Log Carving
 4:30 p.m. Lucas Wilson Illusionist (B)
 7:00 p.m. David Frizzell (M)
 8:30 p.m. Auction of Chainsaw Carvings (M)
 9:00 p.m. Yuk Yuk's Comedy Tour (M)
 9:00 p.m. Main Exhibition Hall Closed
 11:00 p.m. Grounds Closed



MIDWAY SPECIAL

Pay-One-Price for Unlimited Rides
 11:00 a.m. to 10:00 p.m.
 \$28.00 Advance Purchase
 must be made prior to July 23rd

Sunday, July 26th, 2015

**SPONSOR OF THE DAY
TACKABERRY
CONSTRUCTION
ATHENS 613-924-2634**

9:00 a.m. Weigh In / Registration for Tractor Pull
 9:00 a.m. Leads 4-H Dairy Club Achievement
 10:00 a.m. Western Horse Show (H)
 10:00 a.m. Antique Tractor Pull (M)
 10:00 a.m. Main Exhibit Hall Open
 11:00 a.m. Pet Show (I)
 11:00 a.m. Arm Wrestling Registration (P)
 12:00 p.m. Animal Land Opens (A)
 12:00 p.m. Little California (B)
 12:00 p.m. Motorcycle Show and Shine (I)
 12:00 p.m. Arm Wrestling Tournament (P)
 12:00 p.m. Chainsaw Log Carving
 1:00 p.m. Children's Pedal Tractor Pull (M)
 2:00 p.m. Children's Soccer Shoot (I)
 2:00 p.m. Chainsaw Log Carving
 4:00 p.m. Chainsaw Log Carving
 5:00 p.m. Main Exhibition Hall Closed
 5:00 p.m. Cheer for a Year Raffle Conducted \$2080 in LCBO gift cards or \$1800 cash value
 6:00 p.m. Tickets \$10 / Licence #M746233
 Fair Closed
 See You in 2016: July 21st to 24th

SHOW LOCATIONS

Animal Land (A) Horse Ring (H)
 Band Shell (B) Infield (I)
 Cattle Barn (C) Main Stage (M)
 Goat/Sheep Barn (G) Pavilion (P)



MIDWAY SPECIAL

Pay-One-Price for Unlimited Rides
 12:00 p.m. to 6:00 p.m.
 \$28.00 Advance Purchase
 must be made prior to July 23rd

Destination..... Delta Fair

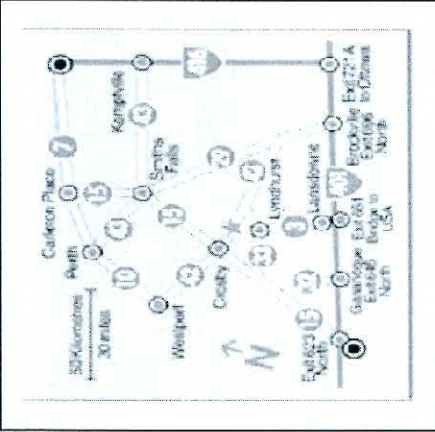

**Grounds
 110 Mill Creek Drive
 Parking Lot / Horse Ring
 12C William Street**

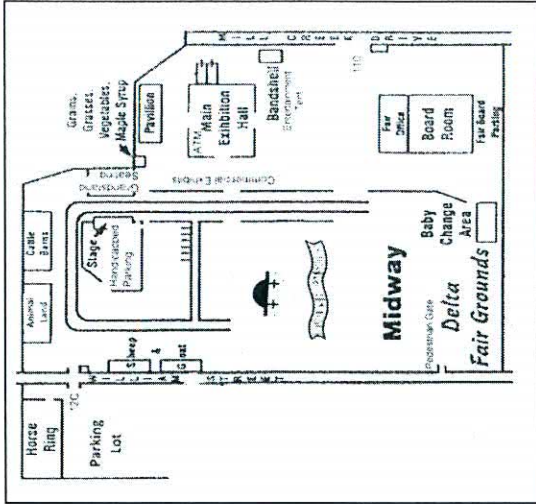

**Mill Creek Drive will be CLOSED during the fair.
 William Street is to be used for All Public Vehicle Access.**



CHEER FOR A YEAR RAFFLE
 \$2080 in LCBO Gift Cards or an \$1800 cash prize
 Draw to be made on July 26th, 2015 at 5:00 p.m.
 Tickets: \$10.00 each Licence Number: M746233

Dates to Remember in 2016

**Maple Syrup Festival: April 16th and 17th
 Delta Fair: July 21st to 24th**